

The AQUAvalve5 is the patented, power-free water control device that regulates the supply of water and fertiliser to your AQUAbox. These Simple Care Guidelines will help ensure your AQUAvalve5 functions perfectly and produces excellent results every time - for years to come.

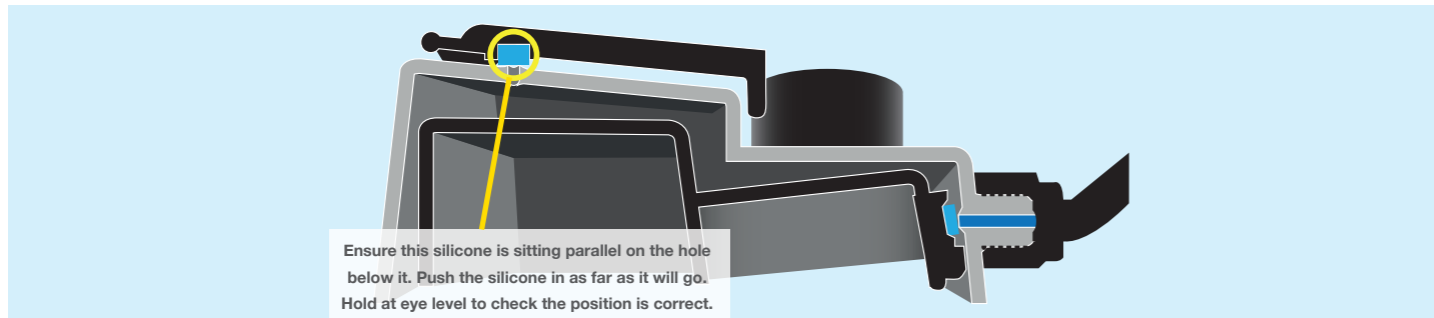

Ensuring that the AQUAvalve5 floods and drains correctly

- 1** Making sure your AQUAvalve5 floods and drains correctly is simply achieved and only takes a few seconds.
- 2** Hold the AQUAvalve5 at eye level so that you can see the silicone fitted to the top float resting on the hole below it.
- 3** The silicone must create a tight seal when touching the hole.
- 4** If it looks like it is not sitting parallel on the hole below, simply lift the top float and apply pressure to one side of the silicone, drop the float and hold at eye level again. Repeat the procedure if necessary.
- !** Properly inserted, the silicone will ensure the AQUAvalve5 floods your tray to 20mm/¾", closes, and then allows the tray to completely drain before reopening. An improperly inserted silicone may prevent the AQUAvalve5 from flooding and draining correctly.

Care and maintenance

- 1** At the end of your growing season, clean the AQUAvalve5 using warm soapy water. Using an old tooth brush will help. The AQUAvalve5 is easily disassembled. The top float will slide all the way across and the bottom float is unclipped from its pivoting position. The circular discs fitted to the top float can also be removed by using pliers to grip the raised point. At this point is it advisable to remove the silicones to avoid them being lost.
- 2** It is also handy to have a paper clip or pipe cleaner to hand so that you can push it through the AQUAvalve5 nozzle, this will remove any limescale build-up that may have occurred during the growing season. Blowing through the AQUAvalve5 nozzle will also help to remove any build up.
Do not use a drill and drill bit to clear the AQUAvalve5 nozzle. This will potentially damage the AQUAvalve5 beyond repair.
- 3** Always flush pipework thoroughly at the end of the growing season to remove any sediment.



Set Up Tips

- 1** Multiple AQUAboxes can be connected together to irrigate and feed larger areas using just one reservoir using the 9mm Tee Connector included. See 'Optional - Using The 9mm Tee Connector' overleaf for full details.
- 2** For best results ensure that your capillary matting strips slope slightly downwards as they spread out across the bed from the AQUAbox in order to ease the flow of water/nutrient solution.
- 3** The lid of the AQUAbox should sit proud of the final soil level and remain uncovered to allow access if required. Keep the lid on the AQUAbox closed at all times, this will prevent rain from washing soil inside.
- 4** Once the AQUAbox is installed and the lid is closed, water the bed through using a hose or watering can. Allow the bed to drain, then plant up. Water the seeds/plants through again to bed them in.



In-Use Tips

- 1** During periods of persistent rain turn your AQUAbox off. This can be done using your inline tap if using the Golf Filter (see Connecting To An Untapped Reservoir overleaf) or your reservoir tap if using the Click Fit Adapter & Filter (see Connecting To A Tapped Reservoir overleaf).
- 2** If your plants are small/young and have not developed a large root system the water can be turned on for a day and then off for 3-4 days. Once the plants have established themselves the water supply can be left on all the time.
- 3** Pre-mixed growing media that includes feed will usually provide sufficient nutrition for up to 8 weeks. If using such media start adding liquid feed to your reservoir after the 6-8th week, following the manufacturers directions.
- 4** Over time you will notice that the growing media will seem dry. There is no need to be concerned as the water is being supplied by the capillary matting below the surface.

mail@autopot.co.uk | www.autopot.co.uk | +44 (0)1276 534900

Endorsed by

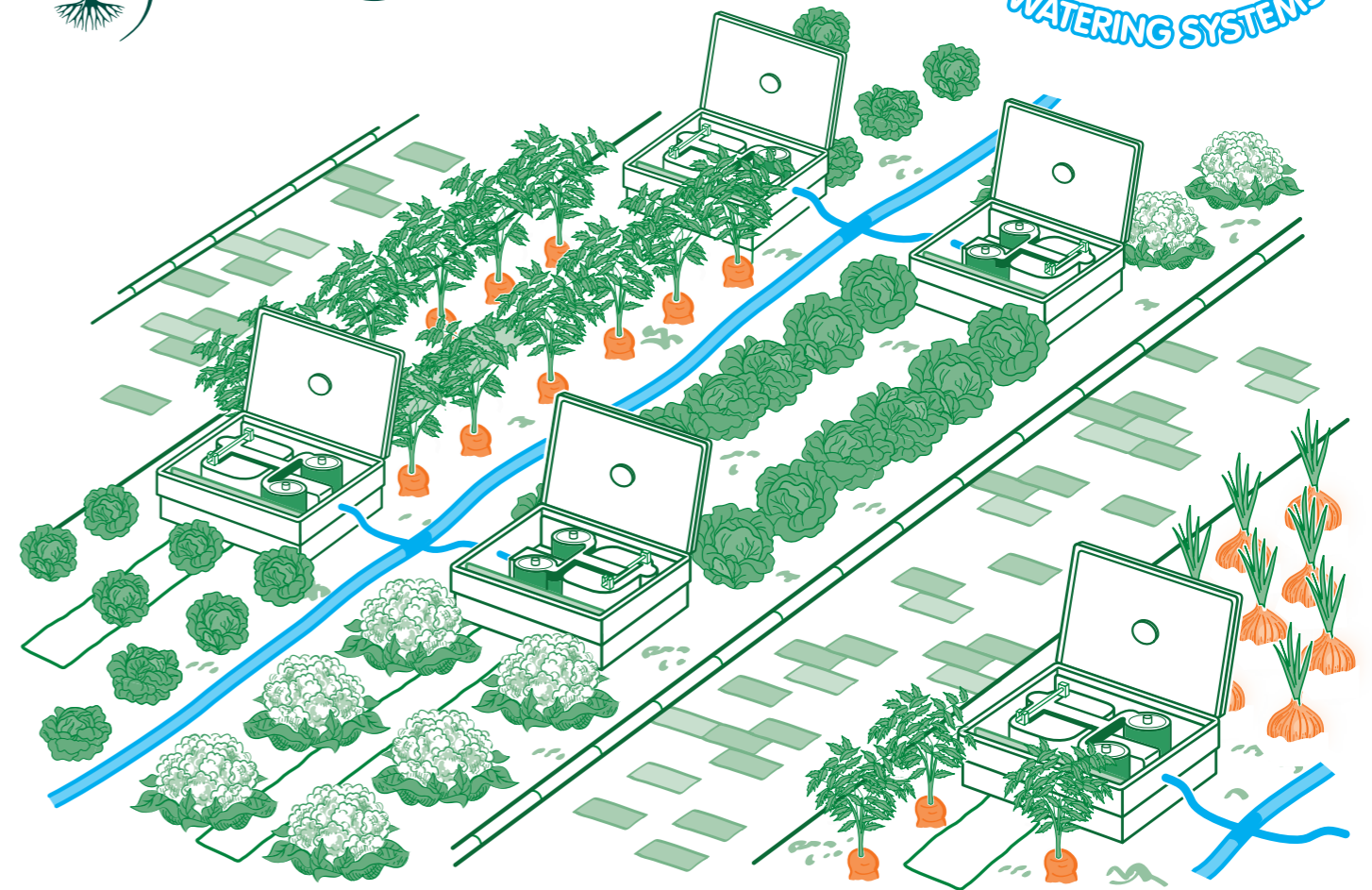

© The Royal Horticultural Society. Trade marks of The RHS (Registered Charity No 222879/SC038262) used under licence from RHS Enterprises Ltd.



Set-Up Guide

Contents

- | | |
|--------------------------|--------------------------------------|
| 1x AQUAbox Straight Body | 1x 9mm Golf Filter |
| 1x AQUAvalve5 | 1x 16-9mm Click Fit Adapter & Filter |
| 1x Circular Spirit Level | 1x 9mm In-line Tap |
| 2x 9mm Grommet | 1x 9mm Tee Connector |
| 2m of 9mm Pipe | 1x 1.2 m Strip Capillary Matting |

Useful Information

Scan For Set-Up Video

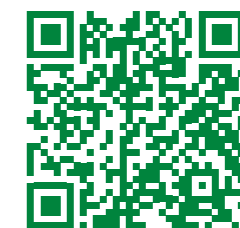

Scan For Product Details



mail@autopot.co.uk | www.autopot.co.uk | +44 (0)1276 534900

AQUAbox Straight Set-Up

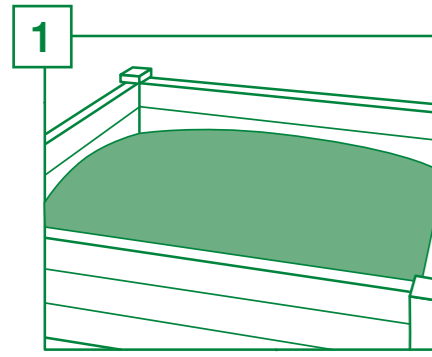

1
Half fill your bed with grow media.
Create a mound in the centre that gently slopes down to the edges.

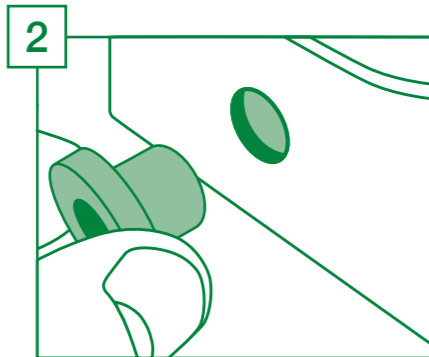

2
Take the AQUAbox Straight Body.
From the outside of the Body push the 9mm grommet into the hole in the Body wall.

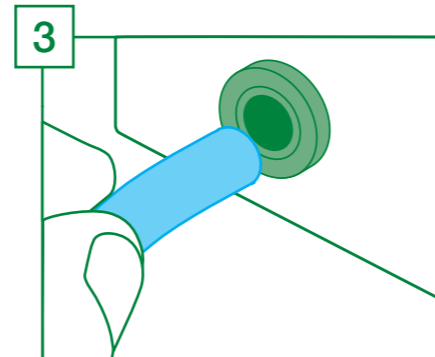

3
Take the 2m length of 9mm pipe.
Push approx 15cm into the Straight Body through the grommet. Wetting the pipe end with cold water helps harden it, aiding insertion.

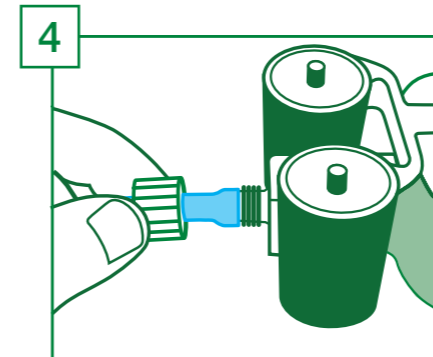

4
Attach the AQUAvalve to the end of the 9mm pipe that you pushed into the Body.
To do so remove AQUAvalve collar. Push the 9mm pipe through collar and attach to AQUAvalve nozzle.

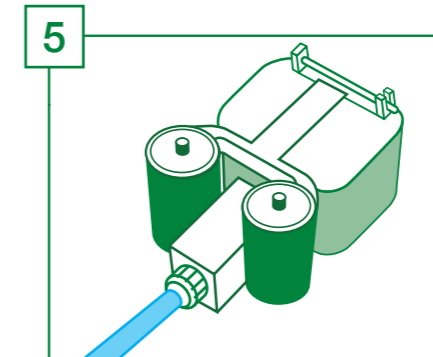

5
Rescrew the AQUAvalve collar - DON'T overturn... when you feel it grip STOP

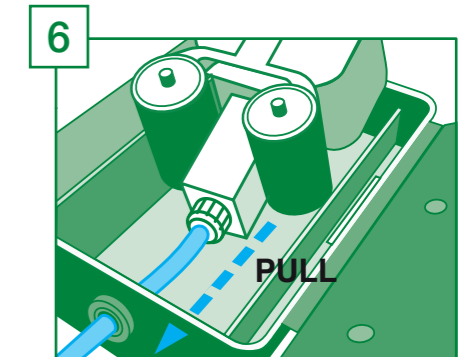

6
Remove any slack in the 9mm pipe by drawing excess out of the AQUAbox Straight Body.

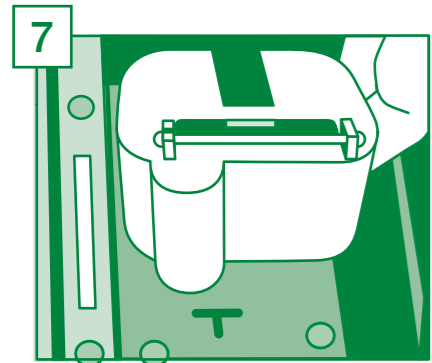

7
Align the 'half moon' section on the rear of the AQUAvalve with the 'T' section in the AQUAbox Straight Body.
Firmly push the AQUAvalve onto the 'T'.

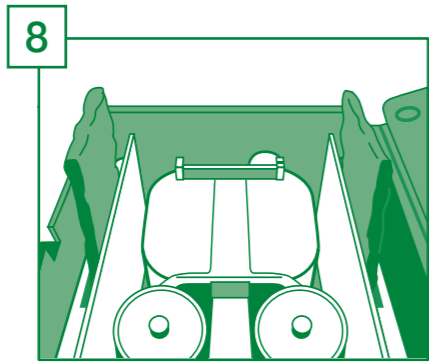

8
Cut your length of capillary matting into two equal pieces and thread in on both sides of the AQUAbox Straight Body

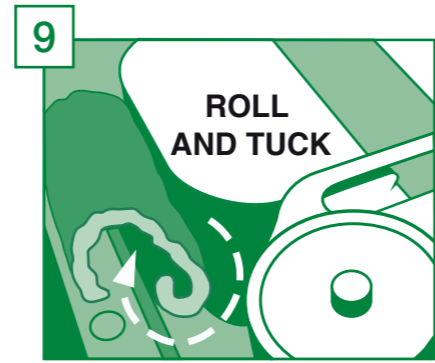

9
Tightly roll both inside ends of the capillary matting and tuck into the AQUAbox alongside the AQUAvalve.
Ensure the ends touch the base of the AQUAbox body.

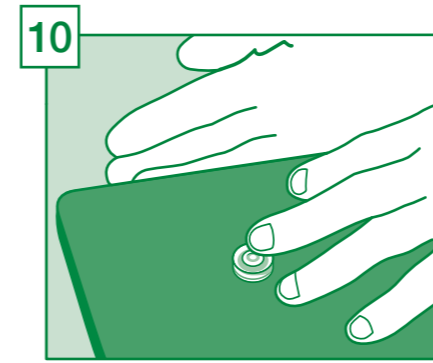

10
Seat AQUAbox in centre of mound created in Step 1.
Push the circular spirit level into the lid of the Body.
Close lid but DO NOT COVER - adjust Body until bubble in the spirit level is centred.

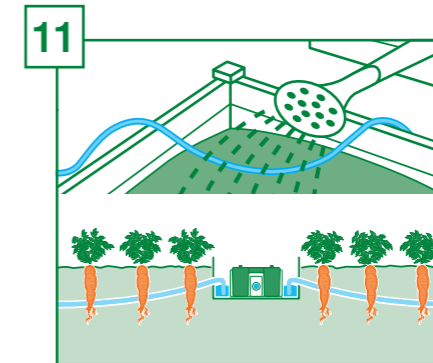

11
Position your capillary matting. For best results ensure that the matting slopes slightly downwards as it runs away from the AQUAbox. This eases the flow of water/nutrient solution.
Cover the capillary strips, water the bed using a hose or can, and allow to drain. Plant the bed up and water through again using a hose or can.

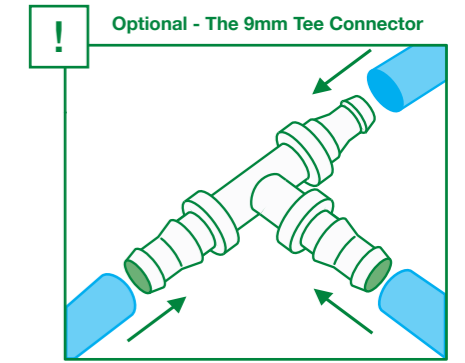

! Optional - The 9mm Tee Connector
Use the 9mm tee connector to run additional AQUAboxes from the same reservoir. This is easily done during setup. If adding to an in-use system ensure your reservoir is switched off. Cut your 9mm pipe at an appropriate point and join the cut lengths to the tee. Attach your additional AQUAbox to the spare connection on the 9mm tee connector.

Connecting To An Untapped Reservoir

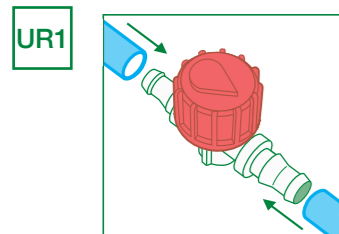

UR1
Take the loose end of your 9mm pipe
Cut 7.5cm in from the end.
Connect cut ends of pipe to 9mm inline tap

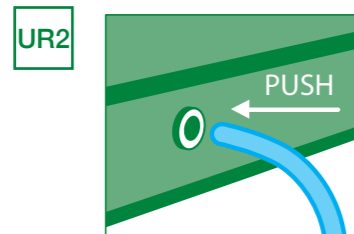

UR2
Make a 12mm dia. hole in your reservoir using a step drill. Push the 9mm grommet into your reservoir.
Push 9mm pipe through grommet.

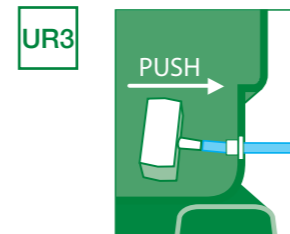

UR3
Inside the reservoir push the 9mm filter into the 9mm pipe.

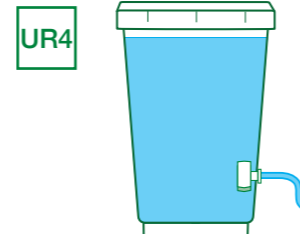

UR4
Elevate your reservoir 150mm above your AQUAbox. Fill your reservoir with water and fertiliser and switch on.

Connecting To A Tapped Reservoir

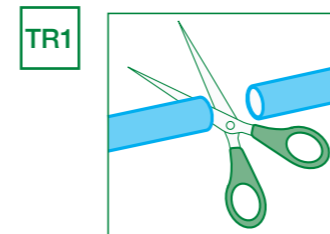

TR1
Take the loose end of your 9mm pipe.
If necessary cut to a length suitable for your setup.

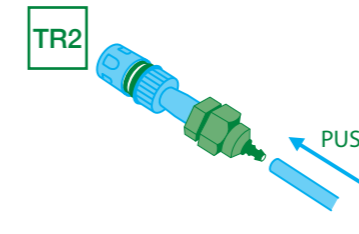

TR2
Connect 9mm pipe to the 16-9mm Click Fit Adapter and Filter.

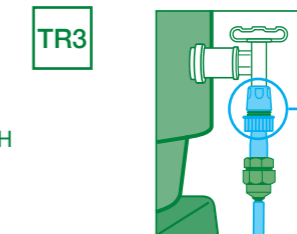

TR3
Connect 16-9mm Click Fit Filter to your reservoir tap. If your tap is not Click-Fit remove the collar from the Filter and push pipe directly onto tap.

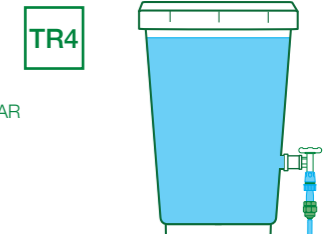

TR4
Elevate your reservoir 150mm above your AQUAbox. Fill your reservoir with water and fertiliser and switch on.